

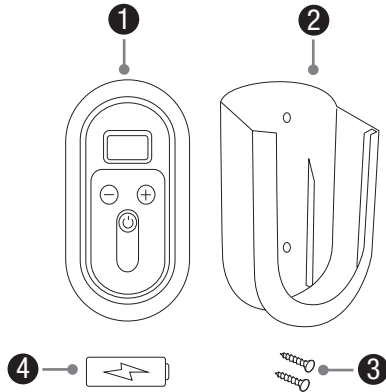

## UNIVERSAL REMOTE FOR ADJUSTABLE FLOW PUMPS

**Universal Remote**  
Item #45041

Contents - #45041	
No.	Description
1.	Universal Remote
2.	Mounting Holster
3.	(2) Mounting Screws
4.	Battery (23A, 12V)



### Instructions

#### INSTALLATION AND OPERATION

- Using a Phillips Head Screwdriver, remove the four screws on the back of the universal remote (Ex. 1).
- Remove the back cover from the remote and place the included battery in the battery compartment (Ex. 2).
- Replace back cover and re-install the four screws to secure.



**NOTE:** In order to control the flow of your Aquascape Adjustable Flow Pump without the use of a smartphone or tablet, you will need to pair the universal remote to your pump receiver.

- The Smart Control Receiver includes a switch that allows the pump to be operated in the two following modes (Ex. 3).
  - Position 1 – Operated by Universal Remote or Aquascape Smart Control App
  - Position 2 – Bypass control and operate at full flow-rate
- Ensure that the receiver is set to Position 1  before beginning the pairing process (Ex. 3).
- Plug the Smart Control Receiver into an outdoor rated GFCI.

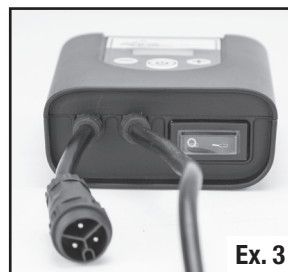

**NOTE:** If the receiver is plugged in and working, unplug the unit and plug it back into the outlet.

- Press and hold the “+” and “-” buttons simultaneously for more than 3 seconds (Ex. 4) to engage the pairing mode (indicated by flashing numbers on the display of the remote).
- Use the “+” and “-” buttons on the remote to select the number “3”.
- After selecting the correct number on the remote, press the power button on the remote to complete pairing the remote to the receiver.



**NOTE:** Complete remote pairing process within 1 minute of connecting the receiver to the power source.

- The universal remote allows for flow adjustment between settings 1 and 10 and well as the ability to turn the pump on/off (Ex. 5).
- For more control, including dynamic scheduling, connect the Smart Control Receiver to the Aquascape Smart Control App and control the pump from your smartphone or tablet (See Smart Control Receiver instructions for more information).

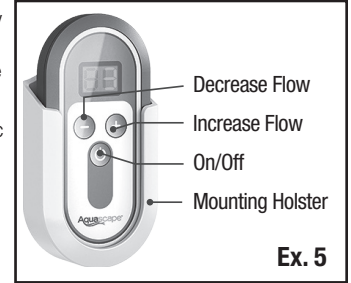

**NOTE:** The Universal Remote has an approximate range of 150 feet/45 meters. The range may be reduced if there are obstacles between the remote and receiver. To control your pump from anywhere, use the Aquascape Smart Control App.

- A mounting holster is included which provides a location to store the remote control. The holster includes an adhesive backing as well as two screws for quick and easy mounting (Ex. 6).
- Mount or store the remote in an area that is protected from the elements.

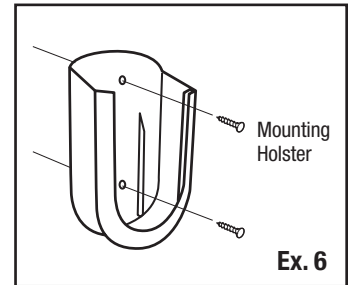

### Troubleshooting

- Remote not controlling the receiver
  - Ensure the receiver switch is set to the correct position
  - Ensure remote battery is functioning
  - Re-pair the remote to the receiver